

Report for: Head of Service for Highways and Parking

Title: Disabled Bay Batch DPB-2022-1A

Report authorised by: Simi Shah, Group Engineer Traffic and Parking
simi.shah@haringey.gov.uk

Report Author/s: Ahnaf Karim, Associate Parking Engineer
ahnaf.karim@haringey.gov.uk

Andrew Bourke, Team Manager Parking Schemes
andrew.bourke@haringey.gov.uk

Ward(s) affected: Northumberland Park, Harringay, Tottenham Central, Crouch End, White Hart Lane, Hornsey, Muswell Hill, Fortis Green, Wood Green, Noel Park.

**Report for Key/
Non-Key Decision: Non-Key decision**

1 Describe the issue under consideration

1.1 To report on the feedback of statutory consultation from 31 August 2022 to 21 September 2022 on the proposals to install and conversion to dedicated disabled bays: Risley Avenue N17, Haslemere Road N8, Northumberland Park N17, Napier Road N17, Devonshire Road N17, Westbeech Road N22, The Roundway N17, Moselle Avenue N22, Greenham Road N10, Woollaston Road N4, North View Road N8, Muswell Hill Road N10, Mayes Road N22.

2 Cabinet Member Introduction

2.1 N/A.

3 Recommendations

3.1 The Head of Service for Highways and Parking.

3.2 Notes approval granted by Cabinet in November 2022 to the Parking Investment Plan, which included

a) Concerning parking investment issues, gives delegated authority to the Head of Highways and Parking:

- To make decisions relating to scheme design and implementation.
- To carry out consultations in accordance with Appendix 2 attached to this report and report any significant or substantial objections or concerns raised to the Cabinet Member for Customer Service, Welfare and the Public Realm; and
- To make traffic management orders, having had due regard to any prior consultation, to give effect to those schemes.

3.3 Having considered proposals, objections to the consultation and officer recommendations, and having due regard to the needs set out in Section 149 of the Equality Act 2010, approve.

3.4 To implement the proposed changes at 13 locations as detailed in Table 1, which includes the following:

- Installation of 9 new dedicated disabled bays
- Upgrading 4 existing disabled bays to dedicated disabled bays
- Removing controlled parking zone restrictions where the introduction of new dedicated disabled bays is approved.

4 Reasons for decisions

4.1 The introduction and removal of dedicated, and general use disabled parking places, as set out in Table 1 Section 6, contributes to the Council meeting its obligations for disabled parking set out in section 149 of the Equality Act 2010 (the Public Sector Equality Duty 'PSED').

4.2 The Council received no objections in response to the proposals advertised within the statutory consultation undertaken during August - September 2022. Thus, officers recommended proceeding with all 13 proposals detailed in Table 1.

4.3 Compliance with the Councils [disabled-parking-place-policy.pdf \(haringey.gov.uk\)](https://www.haringey.gov.uk/sites/default/files/2022-09/disabled-parking-place-policy.pdf).

4.4 The proposals contained within Table 1 impact 2 or more wards; however, in assessing the proposals, officers conclude that the proposed changes are not likely to be significant in terms of

its effects on communities living or working in the area. Therefore, approval can be sought through Delegated Authority in consultation with the Cabinet Member for Customer Service, Welfare, and the Public Realm to make the relevant traffic management orders and implement the recommendations.

5 Alternative options considered

- 5.1 An alternative considered was to 'not undertake the requested introduction of new, upgrade of existing, the extension of existing or removal of no longer required disabled and dedicated disabled bays listed in Table 1. However, this is not recommended as it would be against the Council's current disabled person parking policy and legal requirements set by Department for Transport (DfT).

6 Background

- 6.1 Blue Badge holders in Haringey are entitled to make an application for a dedicated disabled persons' parking bay. These are required to be located close to the applicant's home.

- 6.2 A dedicated disabled persons parking bay (for the sole use by one vehicle) may be recommended if the applicant meets the following criteria (including conversion of a standard disabled persons parking bay to a dedicated disabled persons permit parking bay):

- The applicant must be the holder of a current blue badge issued under the Disabled Persons (Badges for Motor Vehicles) Regulations 2000.
- The applicant must reside permanently at the address; or be able to nominate another driver who also resides permanently at the same address.
- The applicant, or the nominated driver, must have a driver's licence that is registered at the address where the bay is to be provided.
- The applicant must be able to provide written consent (medical consent form) for the Council to access their Blue Badge mobility assessment form and gather evidence to show the applicant has considerable difficulty in walking.
- The applicant has no access to alternative off-street parking. Applications are unlikely to be approved if the applicant has access to off-street parking areas such as a garage, a driveway or an area of hardstanding within their property. Exceptions may be considered if facilities can be demonstrated as being unsuitable for the use of a disabled person due to the nature of their disability.
- The higher rate of the Mobility Component of the disability living allowance elements of the Blue Badge Eligibility criteria; or
- Score 12 points or more under the 'moving around' activity of the mobility component of Personal Independence Payment (PIP); or
- The higher rate Attendance Allowance (aged 64 and over)
- The mobility component of PIP and has obtained 10 points specifically for Descriptor E under the "planning and following journeys" activity on the grounds that they are unable to undertake any journey because it would cause them overwhelming psychological distress; or
- A War Pensioner's Mobility Supplement (WPMS); or
- Has been both awarded a lump sum benefit at tariffs 1-8 of the Armed Forces Compensation Scheme and certified as having an enduring and substantial disability which causes the inability to walk or very considerable difficulty in walking; or
- Provide written evidence from a professional medical consultant (not a general practitioner) providing reasons why a disabled dedicated parking bay is required.

- 6.3 Haringey London Borough Council (hereafter known as 'the Council') continue to provide disabled persons parking bays on the public highway near locations such as hospitals, doctor's surgeries, outside chemists or other public buildings and amenities.
- 6.4 For a person to be eligible to utilise a disabled persons parking bay they must be the holder of a current blue badge issued under the Disabled Persons (Badges for Motor Vehicles) Regulations 2000.
- 6.5 A disabled persons parking bay or dedicated disabled persons parking bay may also be recommended for removal:
- If an individual's circumstances change, whereby the applicant no longer meets the criteria listed in Section 2.2.
 - The applicant; or the applicant's relatives, friends or neighbours; advise the Council that a bay is no longer in use or required.
- 6.6 Occasionally, the Council receive requests to amend existing disabled persons' parking bays or dedicated disabled persons' parking bays where:
- An applicant would like a bay moved closer to their property or facility.
 - An applicant would like a bay to be extended if they feel an existing bay does not or no longer meets their current needs.
- 6.7 In all cases, Council officers will conduct an assessment, which will inform the recommendations in Section 4 of this report.
- 6.8 To proceed with recommendations to introduce, change, relocate or remove a disabled persons parking bay or dedicated disabled persons parking bay, the Council must follow a statutory process.
- 6.9 Due to the volume of applications the Council receives, undertaking each application on an individual basis would not be cost-effective. To efficiently process requests, applications are assessed and progressed in batches covering a period of approximately 2 months.

Proposals

During the most recent period, the Council received 13 requests about disabled persons' parking bays; the introduction of 9 new dedicated disabled parking bays, 4 conversions of 'general use' disabled bays to dedicated disabled bays.

- 6.10 Table 1 below lists locations consisting proposed changes, See **Appendix 1** for detailed drawings:

Table 1

Reference	Location	Description	Reason for proposal and operation hours	Changes to waiting/loading restrictions required? (Y/N)
(1)	Devonshire Road N17 – outside no. 5	Convert existing residential bay to 6.6 metre Dedicated Disabled Permit Bay	To provide a dedicated parking facility to qualifying disabled resident At all times	N
(2)	Westbeech Road N22 – outside no. 4/6	Convert existing residential bay to 6.6 metre Dedicated Disabled Permit Bay	To provide a dedicated parking facility to qualifying disabled resident At all times	N
(3)	North View Rod N8 – opposite no. 41	Convert existing residential bay to 6.6 metre Dedicated Disabled Permit Bay	To provide a dedicated parking facility to qualifying disabled resident At all times	N
(4)	Muswell Hill Road N10 – outside no. 79	Convert existing residential bay to 6.6 metre Dedicated Disabled Permit Bay	To provide a dedicated parking facility to qualifying disabled resident At all times	N
(5)	Napier Road N17 – outside no. 107	Convert existing residential bay to 6.6 metre Dedicated Disabled Permit Bay	To provide a dedicated parking facility to qualifying disabled resident At all times	N

Reference	Location	Description	Reason for proposal and operation hours	Changes to waiting/loading restrictions required? (Y/N)
(6)	The Roundway N17 – outside no. 191/193	Convert existing residential bay to 6.6 metre Dedicated Disabled Permit Bay	To provide a dedicated parking facility to qualifying disabled resident At all times	N
(7)	Alexandra Park Road N22 – outside no. 192	Convert existing residential bay to 6.6 metre Dedicated Disabled Permit Bay	To provide a dedicated parking facility to qualifying disabled resident At all times	N
(8)	Awlfield Avenue N17 – adjacent no. 168 Risley Avenue	Convert existing residential bay to 6.6 metre Dedicated Disabled Permit Bay	To provide a dedicated parking facility to qualifying disabled resident At all times	N
(9)	Haselmere Road N8 – outside no. 16	Convert existing residential bay to 6.6 metre Dedicated Disabled Permit Bay	To provide a dedicated parking facility to qualifying disabled resident At all times	N
(10)	Woollaston Road N4 – outside no. 11	Upgrade existing disabled bay to 6.6 metre Dedicated Disabled Permit Bay	To provide a dedicated parking facility to qualifying disabled resident At all times	N

Reference	Location	Description	Reason for proposal and operation hours	Changes to waiting/loading restrictions required? (Y/N)
(11)	Moselle Avenue N22 – outside no. 28	Upgrade existing disabled bay to 6.6 metre Dedicated Disabled Permit Bay	To provide a dedicated parking facility to qualifying disabled resident At all times	N
(12)	Greenham Road N10 – outside no. 45	Upgrade existing disabled bay to 6.6 metre Dedicated Disabled Permit Bay	To provide a dedicated parking facility to qualifying disabled resident At all times	N
(13)	Northumberland Park N17 – outside no. 127	Upgrade existing disabled bay to 6.6 metre Dedicated Disabled Permit Bay	To provide a dedicated parking facility to qualifying disabled resident At all times	N

Statutory Consultation

6.11 Statutory notification commenced on 31 August 2022 for a period of 21 days. The process consisted of a Notice of Proposal being published in the London Gazette, Enfield and Haringey Independent and street notices being placed in each of the affected streets. The closing date for representations and comments was 21 September 2022.

6.12 See **Appendix 2** for a copy of the statutory 'notice of proposal' advertised. As part of the statutory process, the views of the following statutory bodies were also sought:

- • AA
- • London Transport
- • Police (local)
- • Fire Brigade
- • London Ambulance Service
- • Freight Transport Association
- • Road Haulage Association
- • RAC
- • Metropolitan Police (traffic)
- • London Travel Watch
- • Haringey Cycling Campaign

See **Appendix 3** for a copy of e-mail sent to the above statutory bodies.

Responses to Consultation

6.13 The Legal requirement of statutory consultation was followed with the instalment of street notices and newspaper adverts to notify users of the disabled bays of the statutory consultation and how they could object should they wish to.

6.14 After considering the statutory consultation results and noting that there were no objections to the consultation, therefore recommended that no alterations are made to the proposals listed in **Table 1**.

7 Contribution to strategic outcomes

7.1 The introduction and management of disabled parking places align with the Council's current [Borough Plan](#) and [Transport Strategy](#) section 4 with respect to the management of on-street parking and its prioritisation to those with disability and who live locally.

7.2 The eligibility for the introduction of disabled and dedicated disabled parking places is clearly defined by the current [disabled-parking-place-policy.pdf \(haringey.gov.uk\)](#).

7.3 The use of disabled parking and dedicated parking places contributes to the Council meeting its obligations for disabled parking set out in section 149 of the Equality Act 2010 (the Public Sector Equality Duty ('PSED')). This duty includes having due regard to the need to advance equality of opportunity between persons who share a relevant protected characteristic (including people with a disability) and persons who do not share it.

8 Comments of the Chief Financial Officer

8.1 This report seeks approval from the Head of Service for Highways and Parking to implement the proposed measures for dedicated disabled bays detailed in Table 1.

8.2 The full cost of this scheme is estimated to be approximately £15k in addition to the physical costs 'as detailed in table 3 below'; this cost includes community engagement; inventory of existing site conditions; design, traffic management orders and implementation. To be funded from the Council's approved Capital Programme included within the Parking Implementation Plan.

Table 3

Reference from Table 1	Cost Items	Total Cost	Projected Completion
23 locations (a) - (m)	Road Markings £1000 Signs and Posts £1500 TMO cost £3655	£6,155	To be completed by end of February 2023

8.3 Once implemented the future operation cost will be funded from the existing service revenue budgets.

9 Comments of the Head of Legal Services and Governance

9.1 Before reaching a decision to make the necessary traffic management order to implement changes to existing disabled and dedicated disabled bays, the Council must follow the statutory consultation procedures pursuant to the Road Traffic Regulation Act 1984 (as amended) ("RTRA") and the Local

Authorities' Traffic Orders (Procedure) (England and Wales) Regulations 1996 (as amended) ("the Regulations"). All representations received must be properly considered in the light of administrative law principles, human rights law and the relevant statutory powers.

- 9.2 The Council's powers in relation to the making of traffic management orders arise mainly under sections 6, 9, 45, 46, 122 and 124 and schedules 1 paragraphs 1-22 the RTRA
- 9.3 The power of a local authority to make an order regulating or controlling vehicular and other traffic is contained within the scope of Section 6 of the RTRA.
- 9.4 When determining what paying parking places are to be designated on the highway, section 45(3) requires the Council to consider both the interests of traffic and those of the owners and occupiers of adjoining properties. In particular, the Council must have regard to: (a) the need for maintaining the free movement of traffic, (b) the need for maintaining reasonable access to premises, and (c) the extent to which off-street parking is available in the neighbourhood or if the provision of such parking is likely to be encouraged by designating paying parking places on the highway.
- 9.5 By virtue of section 122, the Council must exercise its powers under the RTRA 1984 so as to secure the expeditious, convenient and safe movement of vehicular and other traffic including pedestrians, and the provision of suitable and adequate parking facilities on and off the highway. These powers must be exercised so far as practicable having regard to the following matters: -
- the desirability of securing and maintaining reasonable access to premises.
 - the effect on the amenities of any locality affected including the regulation and restriction of heavy commercial traffic so as to preserve or improve amenity.
 - the national air quality strategy.
 - facilitating the passage of public service vehicles and securing the safety and convenience of their passengers.
 - any other matters appearing to the Council to be relevant.
- 9.6 The legal position in relation to traffic management orders and the statutory requirements in respect of consultation are set out in Section 9.1 through 9.5 of this report. Public and Statutory Public consultation has been undertaken and due consideration given to representations by the public. The Council would be acting in accordance with the law were it to proceed with the proposals set out in this report.
- 9.7 The proposals contained within this report impact 2 or more wards, however the proposed changes are not "likely to be significant in terms of its effects on communities living or working in an area". Therefore, approval will be sought through Delegated Authority in consultation with the Cabinet Member for Customer Service, Welfare and the Public Realm to make the relevant traffic management orders and implement changes

10 Equalities Comments

- 10.1 The Council has a Public Sector Equality Duty under the Equality Act (2010) to have due regard to the need to:
- Eliminate discrimination, harassment and victimisation and any other conduct prohibited under the Act
 - Advance equality of opportunity between people who share those protected characteristics and people who do not
- 10.2 Foster good relations between people who share those characteristics and people who do not.

- 10.3 The three parts of the duty applies to the following protected characteristics: age, disability, gender reassignment, pregnancy/maternity, race, religion/faith, sex and sexual orientation. Marriage and civil partnership status apply to the first part of the duty.
- 10.4 The Council must, when carrying out the Council's functions (which includes making decisions), have due regard to the needs set out in section 149 of the Equality Act 2010 (the Public Sector Equality Duty ('PSED')). This duty includes having due regard to the need to advance equality of opportunity between persons who share a relevant protected characteristic (including people with a disability) and persons who do not share it. The Council must consider the duty, which is personal to decision makers.
- 10.5 S149 (4) of the Equality Act 2010 stresses the public sector equality duty strongly in respect of disabled persons and extends the meaning of 'due regard' to include the steps involved in meeting the needs of disabled persons in particular "steps to take account of disabled person's disabilities".
- 10.6 The proposal to recommend the lengthening of disabled parking places at various locations in the borough is a necessary step that recognises and takes account of the parking needs of Haringey's disabled residents. It accords completely with meeting the Council's public sector equality duty in regard to the protected characteristic of disability.

11 Use of Appendices

Appendix 1 – Detailed designs showing the extent of the proposals stated in table 1 Section 6

Appendix 2 – Statutory Consultation Notice of Proposal, advertising the proposals Detailed in Table 1 in Section 6

Appendix 3 – Statutory Consultation notification e-mail sent to statutory bodies stated in Section 6.

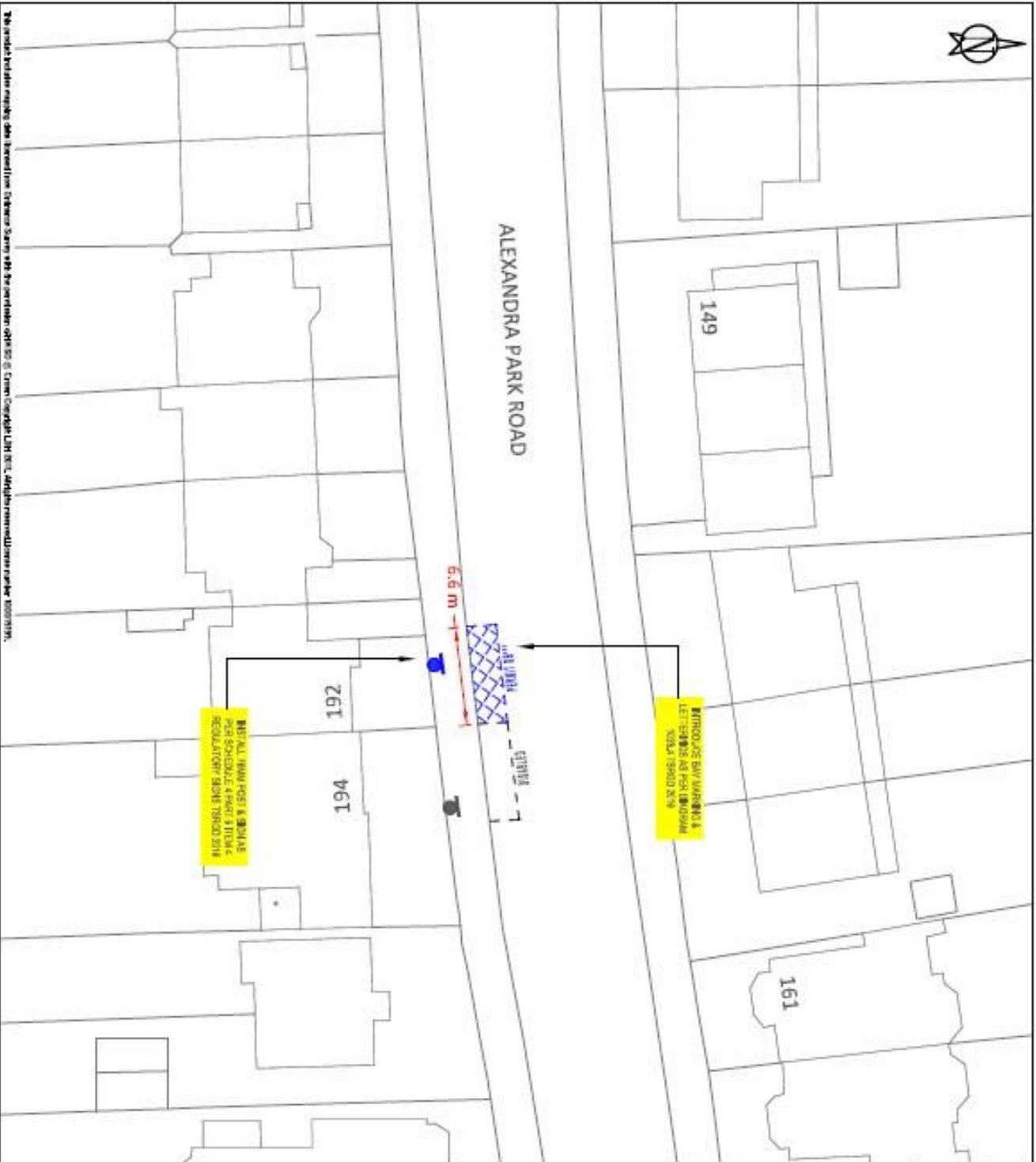

This work has been made possible through the generosity of the following donors: [unreadable text]

REMOVE BAY MARKINGS & LETTERS AS PER DEDICATED PERMIT SIGN

INSTALL NEW POST & SIGN AS PER SCHEDULE 4 PART 3 ITEM 4 REGULATORY SIGN T8800 2018

KEY

- NEW SINGLE YELLOW LINE
- NEW DOUBLE YELLOW LINE
- NEW KERB BAY MARKINGS
- NEW PARKING BAY MARKINGS
- NEW DEDICATED DISABLED PARKING BAY LOCATION
- NEW DEDICATED DISABLED PARKING BAY LOCATION
- NEW TRAMP POST WITH SIGN
- REMOVE SINGLE YELLOW LINE
- REMOVE DOUBLE YELLOW LINE
- REMOVE KERB BAY MARKINGS
- REMOVE PARKING BAY MARKINGS
- REMOVE TRAMP POST WITH SIGN
- LAMP COLUMN WITH SIGN
- DEDICATED KERB CROSSOVER

LOCATION PLAN



SITE LOCATION:

OUTSIDE 192 ALEXANDRA PARK ROAD W22

WORKS:

INSTALL DEDICATED DISABLED PERMIT BAY

NOTES:

SCALE: 1:200 @ A3

DRAWN:	CHECK:	DATE DRAWN:
AK	XX	09/06/2022

BATCH NO.:	DPR-2022-1A
-------------------	--------------------



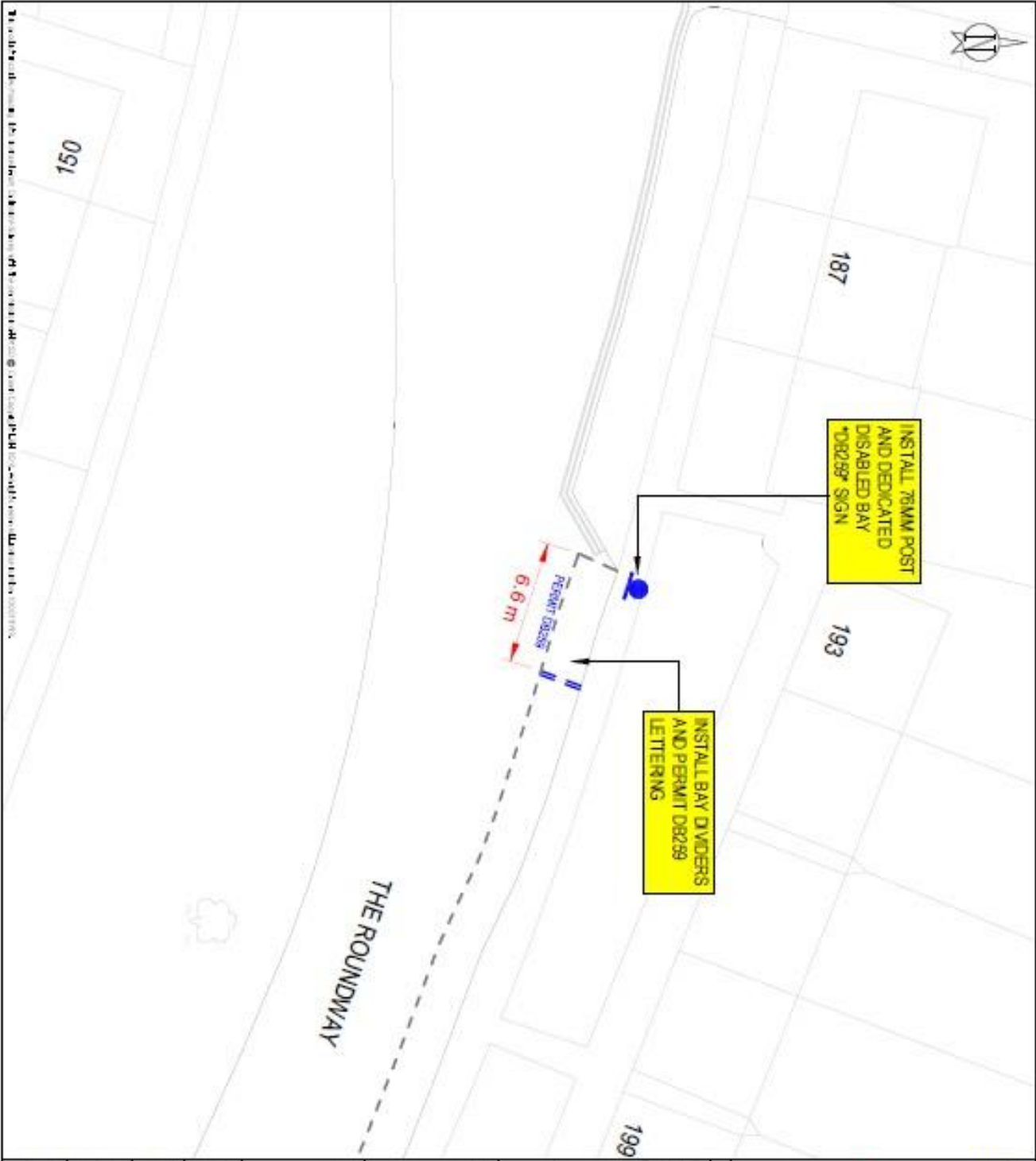

<p>KEY</p> <ul style="list-style-type: none"> — NEW SINGLE YELLOW LINE — NEW MIDDLE YELLOW LINE NEW PERMITS BAY MARKINGS --- NEW PERMITS BAY MARKINGS --- NEW DEDICATED DISABLED PARKING BAY LOCATION --- NEW 75MM POST WITH SIGN --- NEW DEDICATED 75MM POST WITH SIGN --- REMOVE SINGLE YELLOW LINE --- REMOVE MIDDLE YELLOW LINE --- REMOVE PERMITS BAY MARKINGS --- REMOVE PERMITS BAY MARKINGS --- REMOVE 75MM POST WITH SIGN --- REMOVE 75MM POST WITH SIGN --- LAMP COLUMN WITH SIGN --- DROPPED MARKINGS OVER 	
<p>LOCATION PLAN</p>	
<p>SITE LOCATION: Outside 191 to 193 The Roundway N17</p>	
<p>WORKS: Introduce dedicated disabled bay</p>	
<p>NOTES: Open site location to 187 The Roundway N17</p>	
<p>SCALE: A3 @ 1:200</p>	
<p>DRAWN: DB</p>	<p>CHECK: 30/05/2022</p>
<p>DATE DRAWN: 30/05/2022</p>	
<p>BATCH NO.: N/A</p>	

The above information is for information only and does not constitute an offer of any financial product. Please contact your financial adviser for more information.

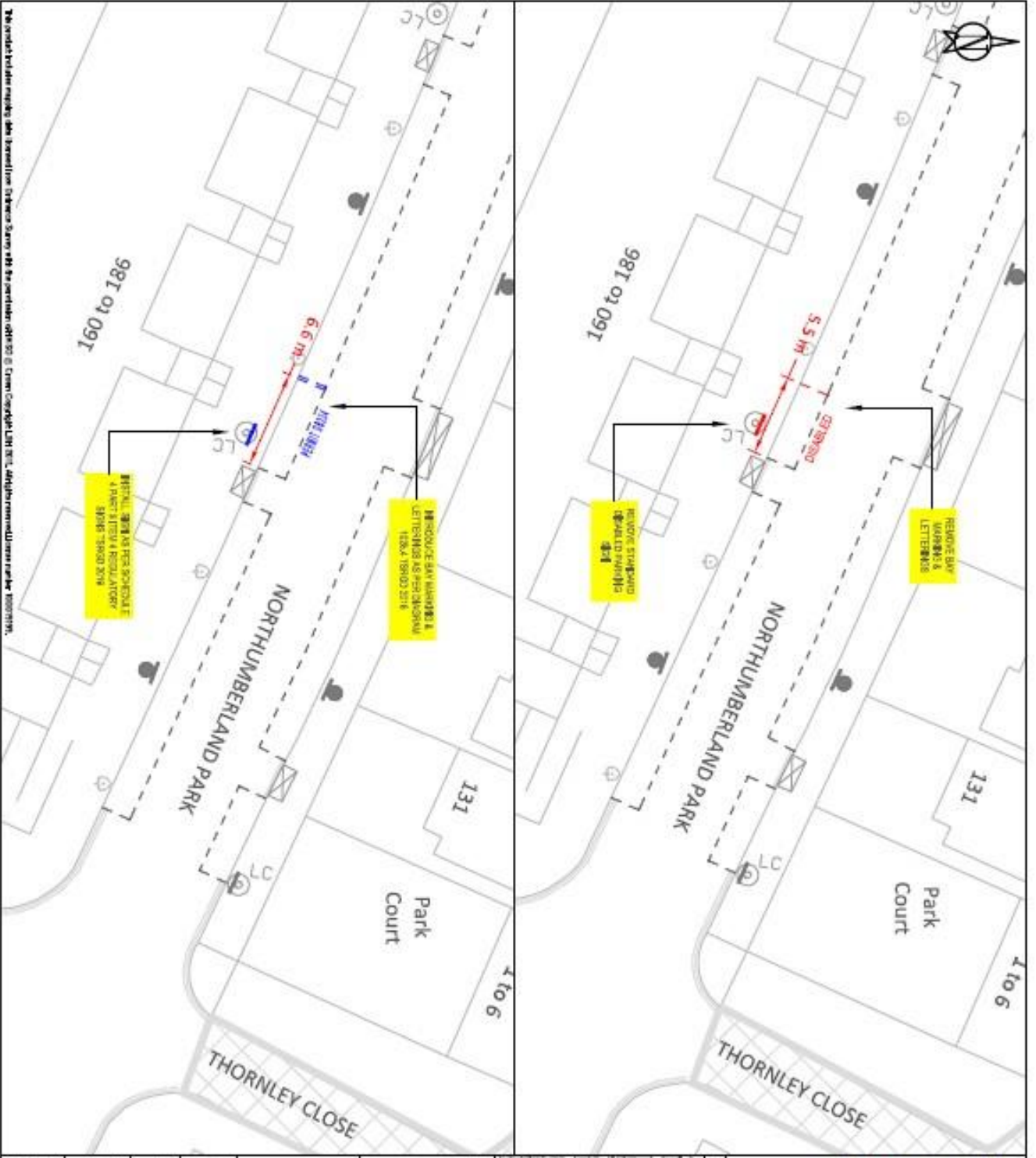

The material and images shown herein are for informational purposes only. © Crown Copyright. All rights reserved. No warranty is made by the Crown.

KEY 	LOCATION PLAN 	
	WORKS: CONVERT 5.5M STANDARD DISABLED BAY TO 6.6M DEDICATED DISABLED PERMIT BAY	
NOTES:		
SCALE: 1:200 @ A3		
DRAWN: AK	CHECK: XX	DATE DRAWN: 10/06/2022
BATCH NO. DRB-2022-1A		
SITE LOCATION: OPPOSITE 127 NORTHUMBERLAND PARK N17		

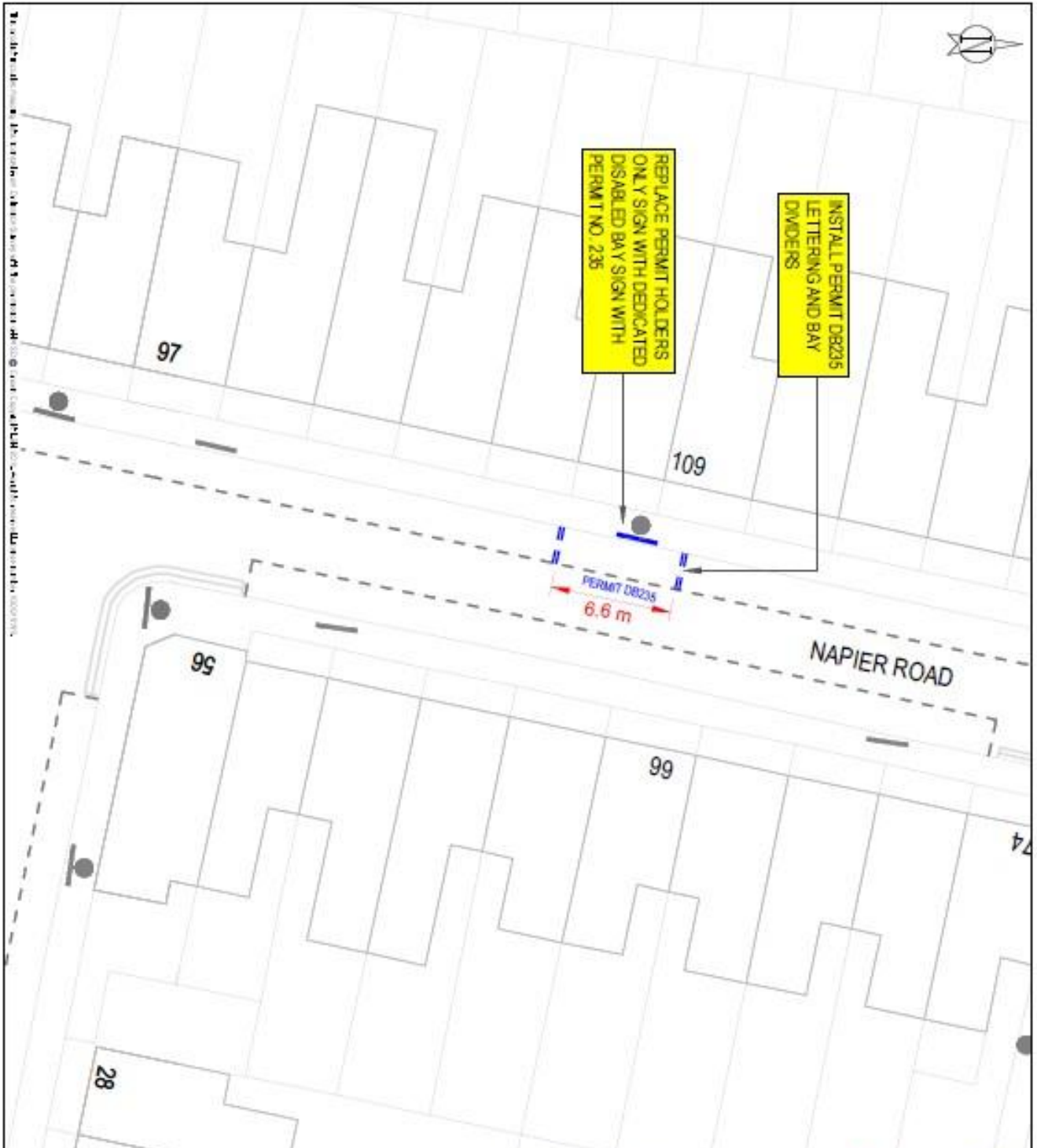

The City of London Corporation, 100 Broad Street, London EC2A 4DP, UK. Tel: 020 7332 3000. Fax: 020 7332 3001. Email: info@cityoflondon.gov.uk

KEY NEW SINGLE YELLOW LINE NEW DOUBLE YELLOW LINE NEW PERMIT BAY MARKINGS NEW PERMIT BAY MARKINGS NEW DEDICATED DISABLED PARKING BAY LOCATION NEW DEDICATED PARKING BAY LOCATION NEW SIGNPOST WITH SIGN REMOVE SINGLE YELLOW LINE REMOVE DOUBLE YELLOW LINE REMOVE PERMIT BAY MARKINGS REMOVE PERMIT BAY MARKINGS REMOVE SIGNPOST WITH SIGN LAMP COLUMN WITH SIGN UNDELETED SIGNPOSTS ONLY		LOCATION PLAN 107 Napier Road N17
		WORKS Convert section of permit holders only bay into a dedicated disabled bay
NOTES	SCALE: A3 @ 1:200	
DRAWN: DB	CHECK: 27/05/2022	DATE DRAWN: 27/05/2022
BATCH NO. N/A		

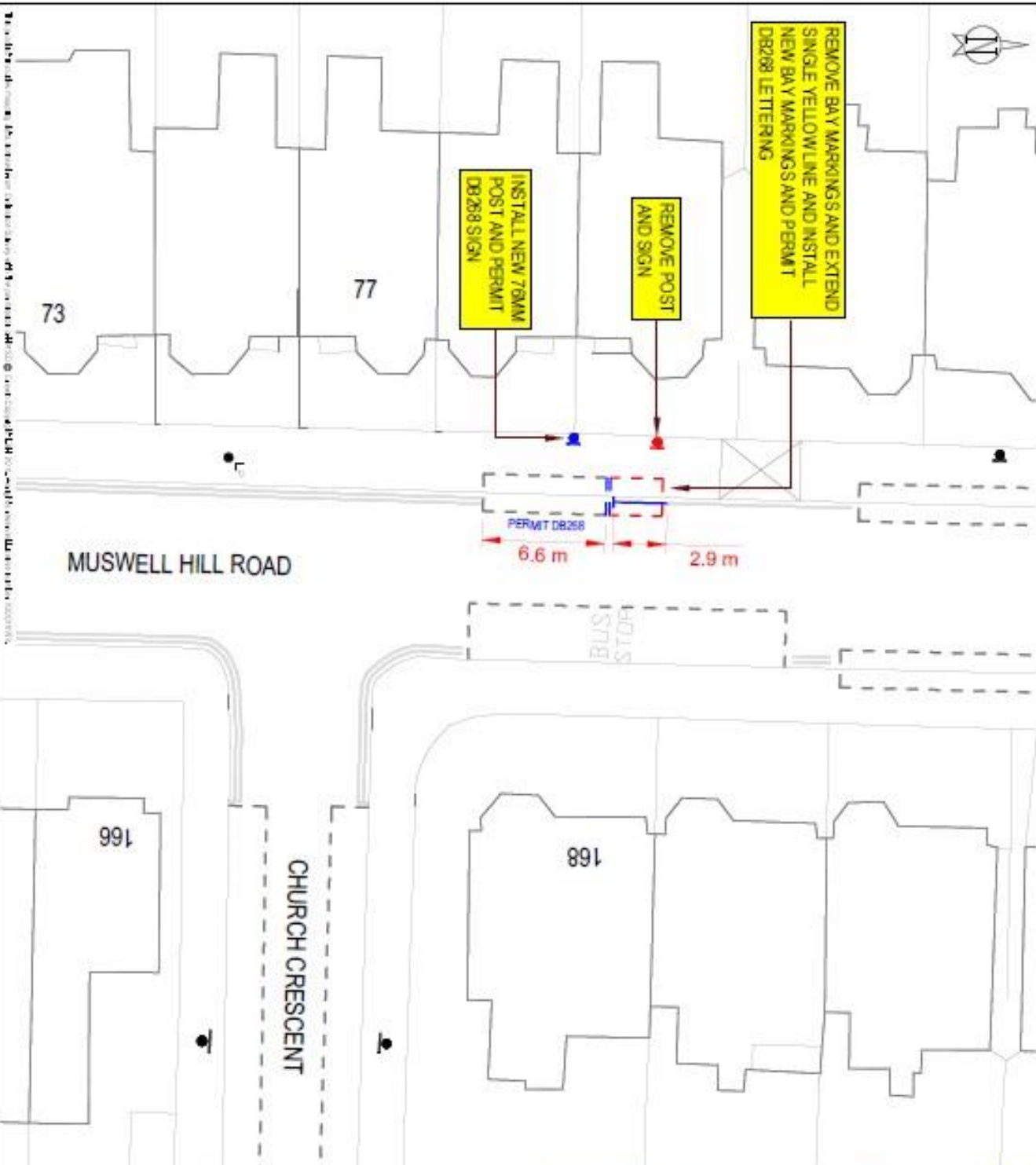

REMOVE BAY MARKINGS AND EXTEND SINGLE YELLOW LINE AND INSTALL NEW BAY MARKINGS AND PERMIT DB268 LETTERING

REMOVE POST AND SIGN

INSTALL NEW T98M POST AND PERMIT DB268 SIGN

73

77

MUSWELL HILL ROAD

PERMIT DB268

6.6 m

2.9 m

BLS STOP

STLS STOP

166

CHURCH CRESCENT

168

KEY 			
WORKS CONVERT 6.6M OF PERMIT BAY INTO A DEDICATED DISABLED BAY AND EXTEND SINGLE YELLOW LINE FOR 2.9M			
NOTES: DEDICATED DISABLED BAY IS FOR NO. 77 AND IS PROPOSED AT THE SAFEST LOCATION			
SCALE: A3 @ 1:200			
DRAWN: DB	CHECK: 01/06/2022	DATE DRAWN:	
BATCH NO.: N/A			
SITELocation: OUTSIDE 79 AND 81 MUSWELL HILL ROAD N10			

The information contained in this document is the property of Haringey Council. It is not to be used for any other purpose without the Council's permission.

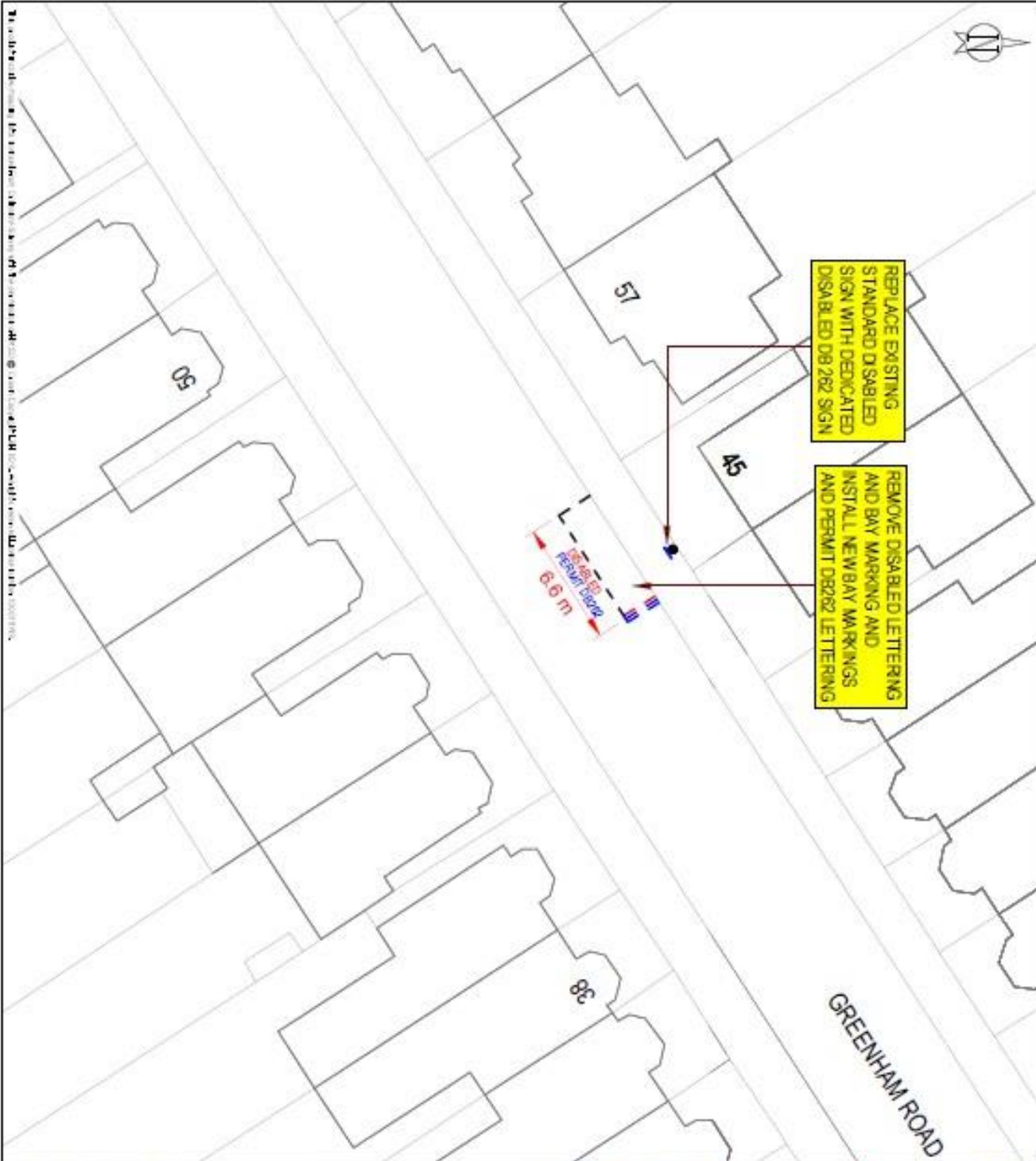

<p>KEY</p> <ul style="list-style-type: none"> NEW SINGLE YELLOW LINE NEW DOUBLE YELLOW LINE NEW PARALLEL BAY MARKINGS NEW DEDICATED DISABLED PARKING BAY LOCATION NEW DISABLED ENTRANCE/EXIT LOCATION NEW DISABLED METER SIGN NEW SINGLE YELLOW LINE REMOVE DOUBLE YELLOW LINE REMOVE PARALLEL BAY MARKINGS REMOVE DISABLED BAY MARKINGS REMOVE PERMIT SIGN LAMP COLUMN WITH SIGN PROPOSED KERB/OBSTACLE 	<p>LOCATION PLAN</p>			
	<p>SITE LOCATION: 45 Greenham Road N10</p>	<p>WORKS: Convert standard disabled bay into a dedicated disabled bay</p>		
<p>NOTES:</p>	<p>SCALE: A3 @ 1:200</p>	<p>DRAWN: DB</p>	<p>CHECK: DB</p>	<p>DATE DRAWN: 31/05/2022</p>
<p>BATCH NO: N/A</p>				

The above information is provided as a guide only. It is not intended to be used as a basis for any legal proceedings.



NORTH VIEW ROAD

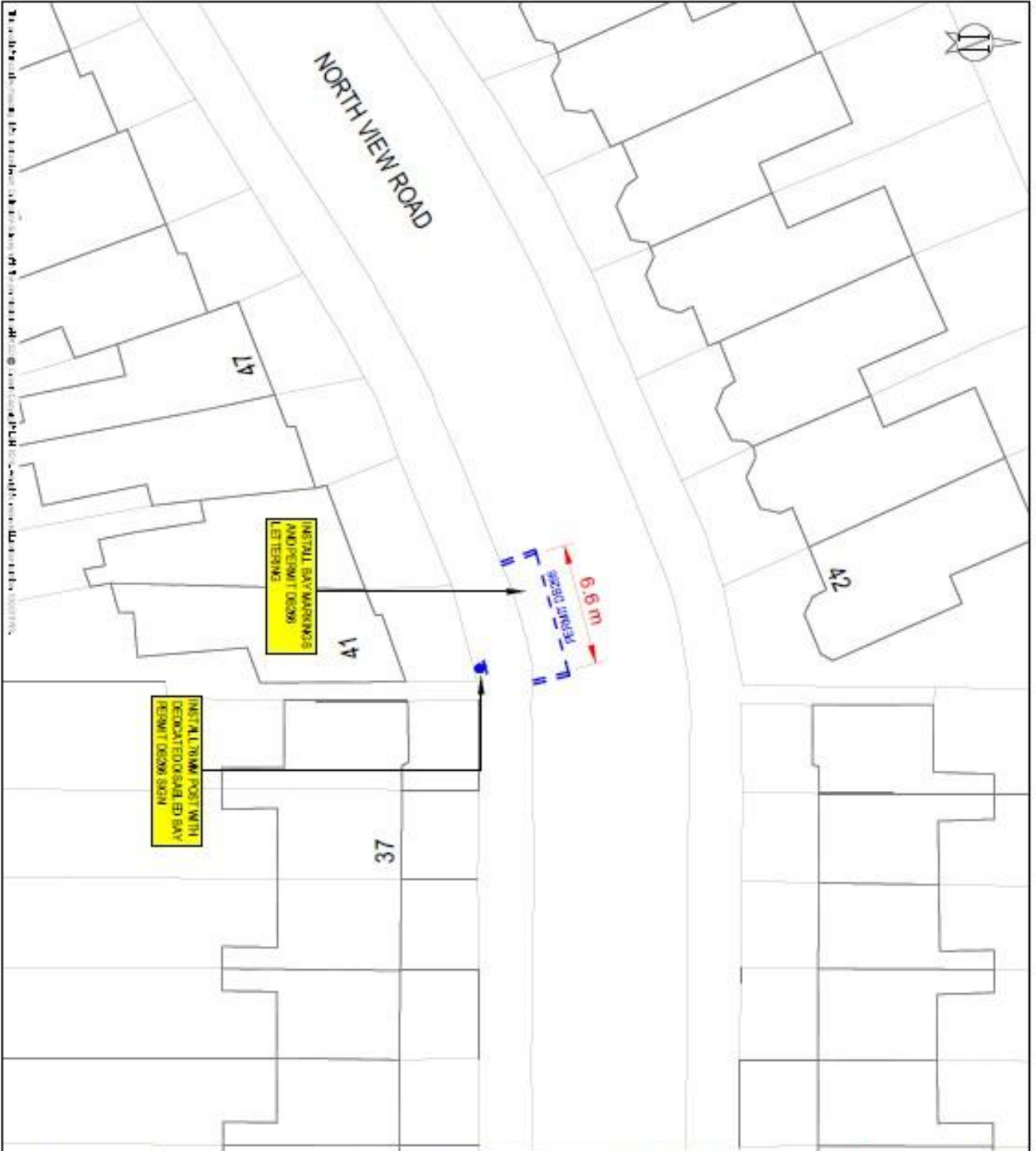

KEY

- NEW SINGLE YELLOW LINE
- NEW DOUBLE YELLOW LINE
- NEW PARKING BAY MARKINGS
- NEW CLEAR/DELETED PARKING BAY LOCATION
- NEW/REMOVED NIP SIGN
- REMOVE SINGLE YELLOW LINE
- REMOVE DOUBLE YELLOW LINE
- REMOVE KERBEL PARKING BAYS
- REMOVE PARKING BAY MARKINGS
- REMOVE TRAMPPOST WITH SIGN
- LAMP COLUMN WITH SIGN
- DELETED KERBEL SIGN OVER



SITE LOCATION
41 North View Road NS

WORKS
Introduce new dedicated disabled bay

NOTES

SCALE:
A3 @ 1:200

DRAWN: DB	CHECK:	DATE DRAWN: 31/05/2022
---------------------	---------------	----------------------------------

BATCH NO.
N/A

These drawings are the property of Haringey Council and are not to be reproduced without the Council's permission.

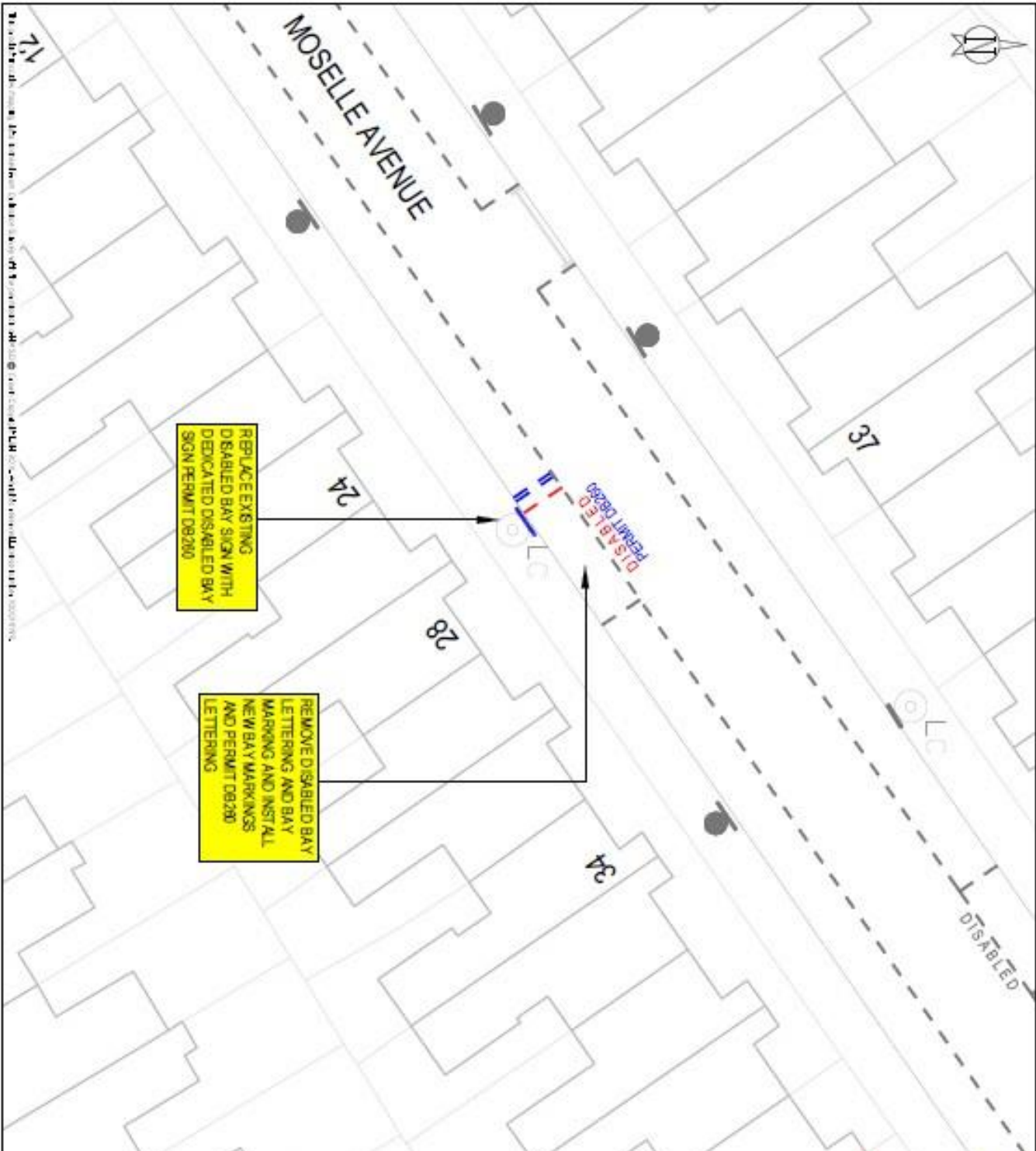

<p>KEY</p> <ul style="list-style-type: none"> REMOVE YELLOW LINE REMOVE YELLOW LINE REMOVE BAY MARKINGS REMOVE EXISTING DISABLED PARKING BAY LOCATION REMOVE EXISTING BAY LOCATION NEW PARKING BAY SIGN REMOVE SINGLE YELLOW LINE REMOVE DOUBLE YELLOW LINE REMOVE PERMIT PLAKES REMOVE PARKING MARKINGS REMOVE SIGNPOST WITH SIGN REMOVE SIGNPOST WITH SIGN REMOVE SIGNPOST WITH SIGN REMOVE SIGNPOST WITH SIGN 	<p>LOCATION PLAN</p>	<p>SITE LOCATION 28 Moselle Avenue NZ2</p>	<p>WORKS Convert existing standard disabled bay into a dedicated disabled bay</p>	<p>NOTES</p>	<p>SCALE: A3 @ 1:200</p> <table border="1"> <tr> <td>DRAWN: DB</td> <td>CHECK:</td> <td>DATE DRAWN: 31/05/2022</td> </tr> <tr> <td colspan="2">BATCH NO. N/A</td> <td></td> </tr> </table>	DRAWN: DB	CHECK:	DATE DRAWN: 31/05/2022	BATCH NO. N/A		
DRAWN: DB	CHECK:	DATE DRAWN: 31/05/2022									
BATCH NO. N/A											

This document is the property of Haringey Council and should not be distributed outside the Council.

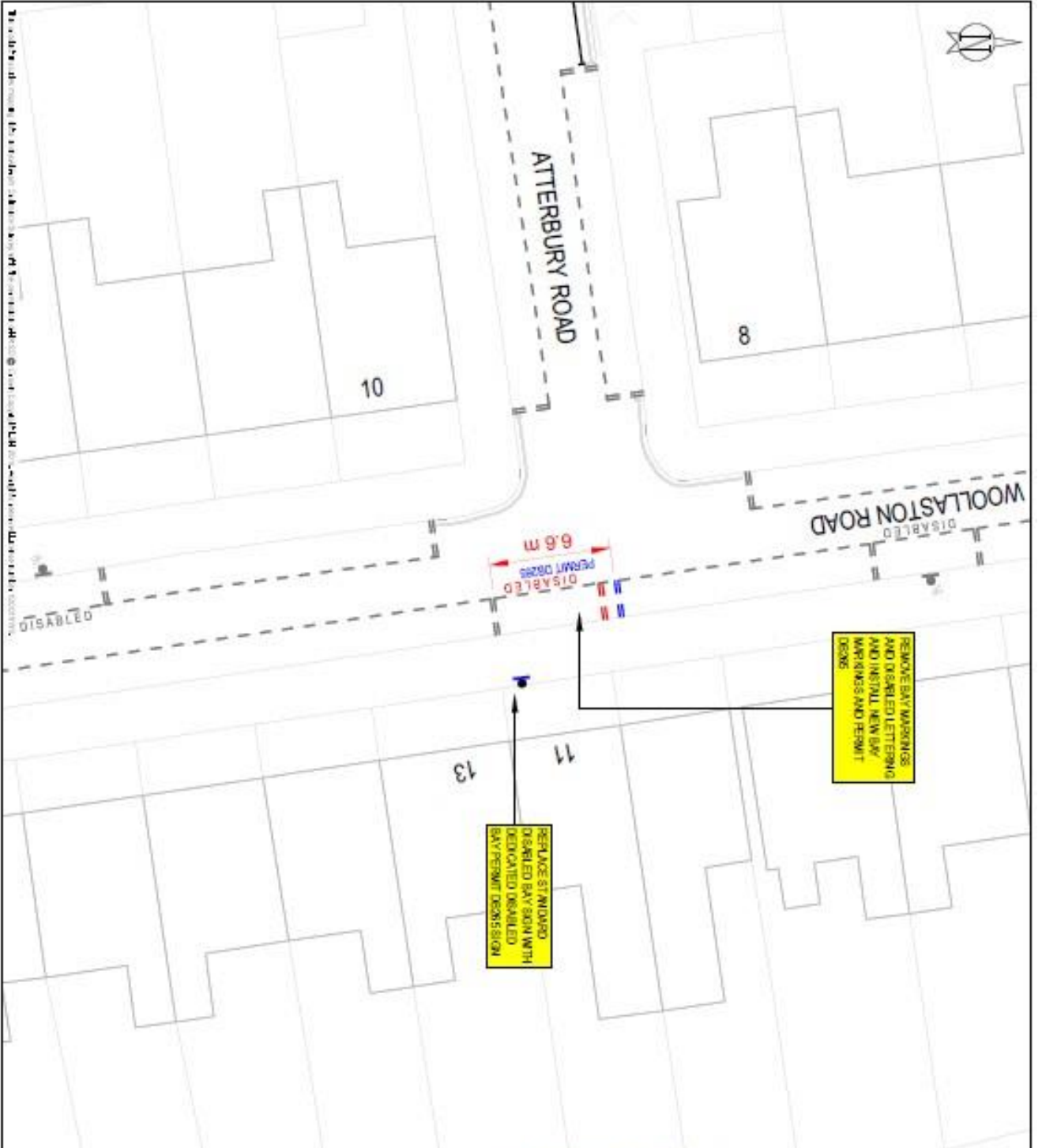

REMOVE PAVER MARKINGS AND INSTALL NEW BAY MARKINGS AND PERMIT DRIVERS

REPLACE STANDARD DISABLED BAY SIGN WITH ADAPTED DISABLED BAY PERMIT DESIGNATION

<p>KEY</p> <ul style="list-style-type: none"> NEW/SIDE YELLOW LINE NEW/CURB YELLOW LINE NEW/STANDARD BAY MARKINGS NEW/STANDARD BAY MARKINGS NEW/ADAPTED DISABLED PARKING BAY CREATION NEW/STANDARD BAY CREATION NEW/ADAPTED BAY SIGN REMOVE/DRAWN YELLOW LINE REMOVE/STANDARD BAY MARKINGS REMOVE/STANDARD BAY MARKINGS REMOVE/ADAPTED BAY SIGN REMOVE/STANDARD SIGN REMOVE/ADAPTED SIGN 	
<p>LOCATION PLAN</p>	
<p>SITE LOCATION: 11 Woollaston Road, NI</p>	
<p>WORKS: Convert existing standard disabled bay into a dedicated disabled bay</p>	
<p>NOTES:</p>	
<p>SCALE: A3 @ 1:200</p>	
<p>DRAWN: DB</p>	<p>CHECK: S.M.S./2022</p>
<p>DATE DRAWN:</p>	
<p>BATCH NO.: N/A</p>	

The information contained in this document is the property of Haringley Limited. It is to be used only for the purposes for which it is provided. Haringley Limited does not accept any liability for the use of the information contained in this document.

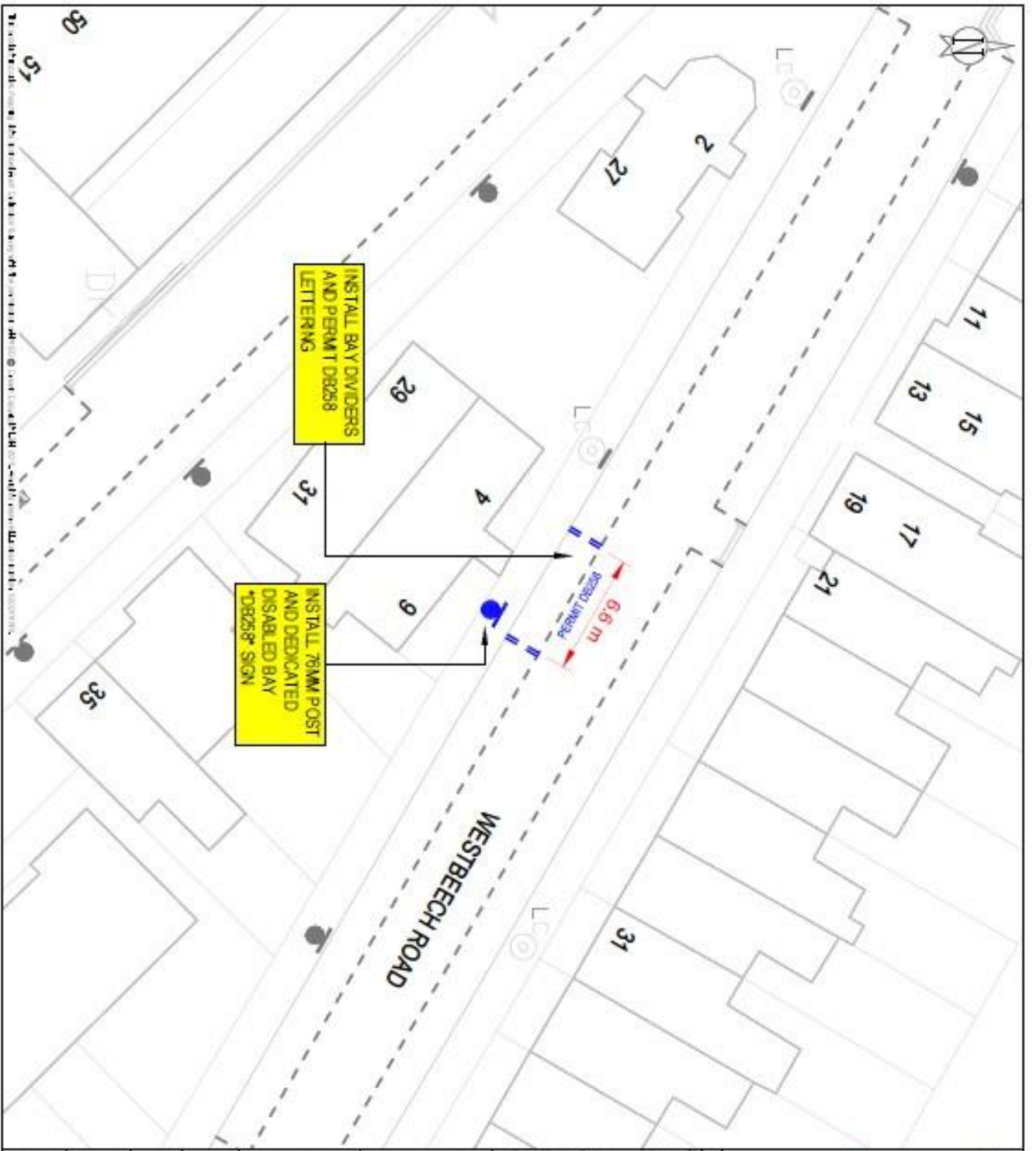

KEY NEW SINGLE YELLOW LINE NEW DOUBLE YELLOW LINE NEW BAY DIVIDERS NEW DEDICATED DISABLED PARKING BAY LOCATION NEW 76MM POST WITH SIGN REMOVE SINGLE YELLOW LINE REMOVE DOUBLE YELLOW LINE REMOVE PERMITTED PARKING BAY REMOVE PERMITTED PARKING BAY REMOVE 'SHARLOT' WITH SIGN REMOVE PERMITTED SIGN REMOVE PERMITTED SIGN	LOCATION PLAN
	WORKS: Convert section of shared use, resident and pay by phone into a dedicated disabled bay
NOTES:	SITE LOCATION: 6 Westbeech Road NZ2
SCALE: A3 @ 1:200	DRAWN: DB
CHECK:	DATE DRAWN: 30/05/2022
BATCH NO. N/A	

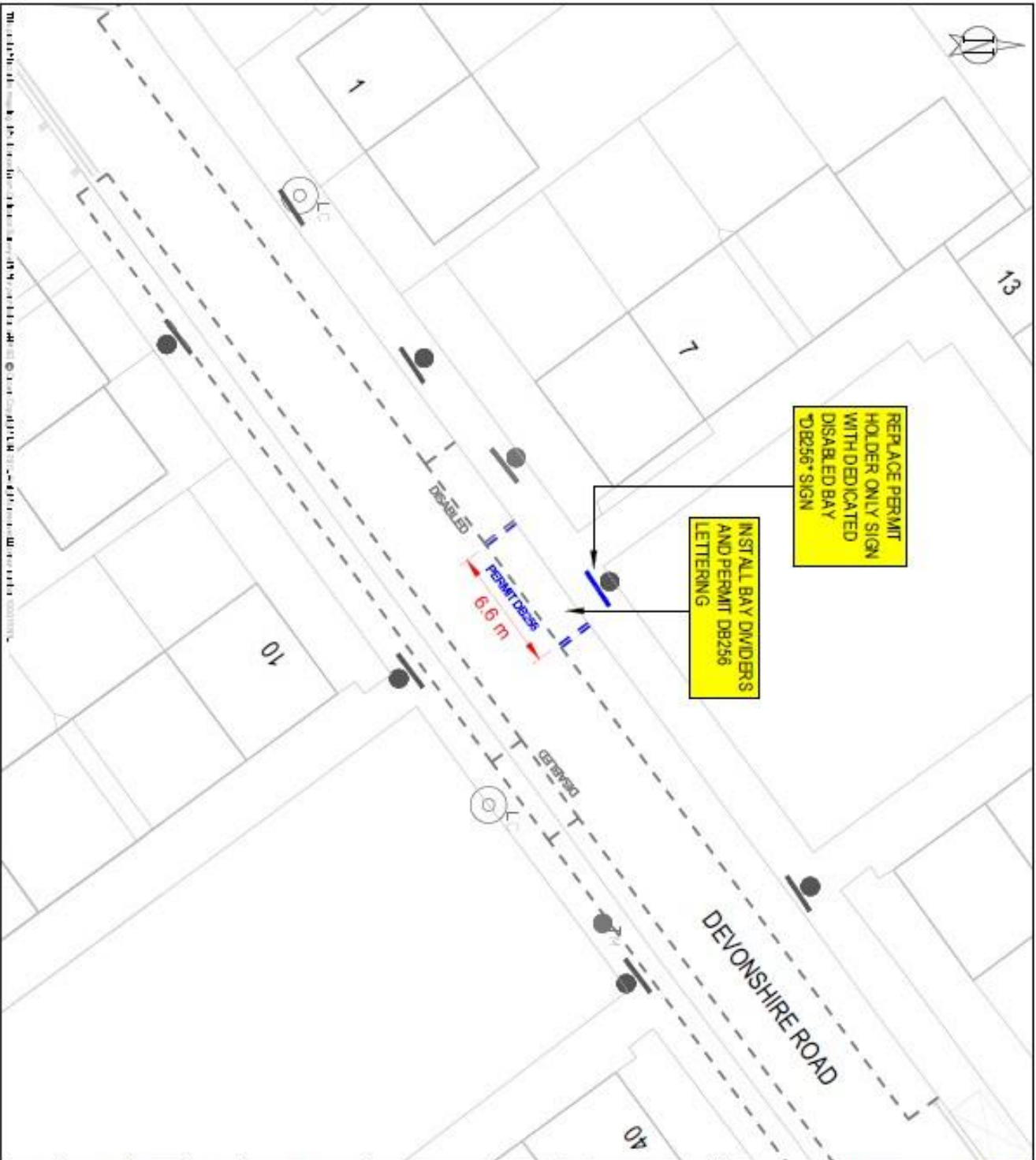

KEY

- NEW SINGLE YELLOW LINE
- NEW DOUBLE YELLOW LINE
- NEW BAY DIVIDER MARKINGS
- NEW PARKING BAY MARKINGS
- NEW DEDICATED DISABLED PARKING BAY LOCATION
- NEW DISABLED PARKING BAY LOCATION
- NEW TRAFFIC LIGHT SIGN
- REPLACE SINGLE YELLOW LINE
- REPLACE DOUBLE YELLOW LINE
- REPLACE BAY DIVIDER MARKINGS
- REPLACE PARKING BAY MARKINGS
- REPLACE TRAFFIC LIGHT SIGN
- LAMP COLUMN WITH SIGN
- EXISTING SIGNAGE/POSTER

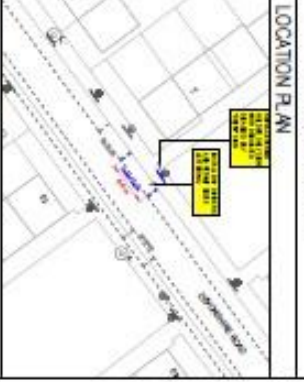

SITE LOCATION:
Outside 5 Devonshire Road M17

WORKS:
Convert section of permit holder only bay into a dedicated disabled bay

NOTES:

SCALE:
A3 @ 1:200

DRAWN: DB	CHECK:	DATE DRAWN: 30/05/2022
BATCH NO.: N/A		

The City of London Corporation, City Hall, Old Broad Street, London EC2A 4PU, UK
 Tel: 020 7321 2000
 Email: cityoflondon@cityoflondon.gov.uk
 Website: www.cityoflondon.gov.uk

Public Notice



HARINGEY COUNCIL – PUBLIC NOTICE

**PROPOSED DEDICATED DISABLED PARKING PLACES BATCH 2022-01A, VARIOUS ROADS,
LONDON BOROUGH OF HARINGEY,
THE HARINGEY (FREE PARKING PLACES, LOADING PLACES AND WAITING, LOADING AND
STOPPING RESTRICTIONS) (AMENDMENT NO.***) ORDER 202*
THE HARINGEY (CHARGED-FOR PARKING PLACES) (AMENDMENT NO. ***) ORDER 202***

T39

Notice is hereby given that the Council of the London Borough of Haringey proposes to make the above-mentioned Orders under sections 6, 45, 46, 49 and 124 of and Part IV of Schedule 9 to the Road Traffic Regulation Act 1984, and of all other powers.

The General Effects of the Orders would be:

- (i) **To introduce Dedicated Disabled Parking Bays**, operating at any time, measuring a length of 6.6 metres, outside (unless stated otherwise) the following properties in the London Borough of Haringey; No.5 Devonshire Road N17, No.4/No.6 Westbeech Road N22, No.41 North View Road N8, No.79 Muswell Hill Road N10, No.107 Napier Road N17, No.191/193 The Roundway N17, No.192 Alexandra Park Road N22, Awlfield Avenue N17 adjacent to No.168 Risley Avenue, Flat No.16 Haselmere Road N8 .
- (ii) **To convert existing Disabled Parking Bays to Dedicated Disabled Permit Holders Only Parking Bays**, operating at any time, whilst also extending them to measure 6.6 metres in length, outside (unless otherwise stated) the following properties in the London Borough of Haringey; No.11 Woollaston Road N4, No.28 Moselle Avenue N22, No.45 Greenham Road N10, opposite No.127 Northumberland Park N17,
- (iii) To extend the existing single yellow line outside No.81 Muswell Hill Road N10 by 2.9 metres.

The Dedicated Disabled Parking Bay would specifically be for the use of the permit holder for which it would be authorised. No other permit or blue badge would be valid for use within the proposed parking place except for the permit for which it was issued.

- (vi) To revoke the relevant underlying Controlled Parking Zone restrictions at the locations mentioned in Section 2(i) of this notice.

Copies of the proposed Order and of the Council's statement of reasons for making the Order and plans showing the locations and effects of the Order may be inspected during normal office working hours until the end of a period of 6 weeks from the date on which the Order is made or the Council decides not to make the Order, at the reception desk, Alexandra House, 10 Station Road, Wood Green, N22 7TR or can be viewed online at <https://consultation.appyway.com/haringey>

Any person wishing to object to the proposed Order or make other representation should send grounds for their objection via the online portal <https://consultation.appyway.com/haringey> or alternatively email traffic.orders@haringey.gov.uk or write to Traffic Management Group, River Park House, 1st floor, 225, High Road, Wood Green, N22 8HQ quoting reference 2022-T39, by 21st September 2022.

Date: 31st August 2022

Ann Cunningham,
Head of Highways and Parking

APPENDIX 3

Dear all

I attach documents relating to proposed/made Traffic Orders and should be grateful for any objections or representations that you may have regarding any proposed permanent Orders within 21 days from the date of this email, and within 6 months from the in force dates for any experimental Orders. If I do not hear from you, I will assume that you have no comments to make.

Regards

Paul Chambers
Traffic Order Officer

Haringey Council
Traffic Management Group, Alexandra House, 5th Floor, 10 Station Road, Wood Green, N22 7TR

T. 020 8489 5323

E. paul.chambers@haringey.gov.uk